

PowerWalker VI 500-1500 THID

Quick Guide

I. Front Panel:

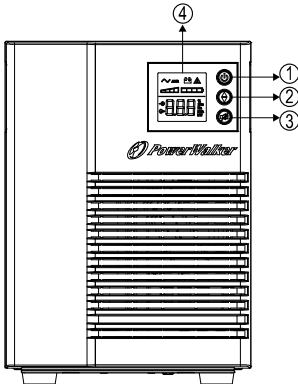

1. ON/OFF button
2. Scroll down button
3. Mute button
4. LCD display

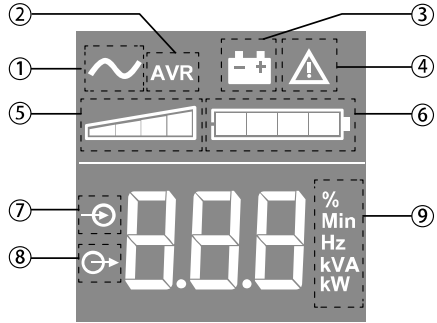

1. UPS ON
2. AVR mode
3. Battery mode
4. Internal fault
5. Output load level
6. Battery level
7. Input measurements
8. Output measurements
9. Measuring unit

II. Rear Panel:

VI 500T/750T

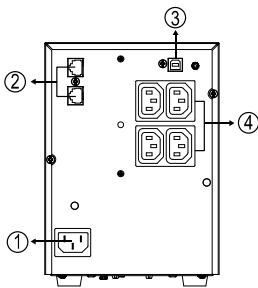

VI 1000T/1500T

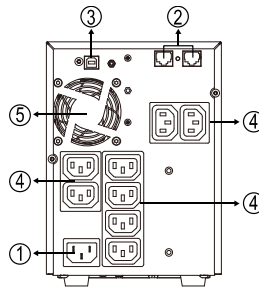

1. AC input
2. RJ11/RJ45 LAN/Modem/phone line protection
3. USB port
4. IEC outlet
5. Fan

III. UPS setting through the LCD:

Hold scroll down button to select menu

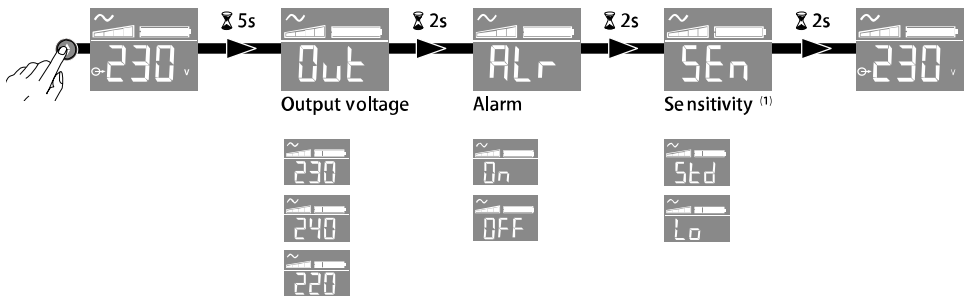

Select value and wait 10s until it saves the setting and returns to main screen. LCD will shut off if there is no activity for 3 minutes.

In low sensitivity mode (Sen : Lo) UPS will tolerate more fluctuations in power and will go on battery power less often. If the connected load is sensitive to power disturbances, keep the sensitivity as Standard (Std).

IV. Audio Indicator

<u>Audible Alarm</u>	<u>Situation</u>
Sounding every 10 seconds	Battery Mode
Sounding every 3 seconds	Battery Low
Sounding every 3 seconds	Overload
Sounding every 1 seconds	Faulty

V. Battery-module replacement

This operation must be performed when the UPS is switched OFF, and unplugged from AC source.

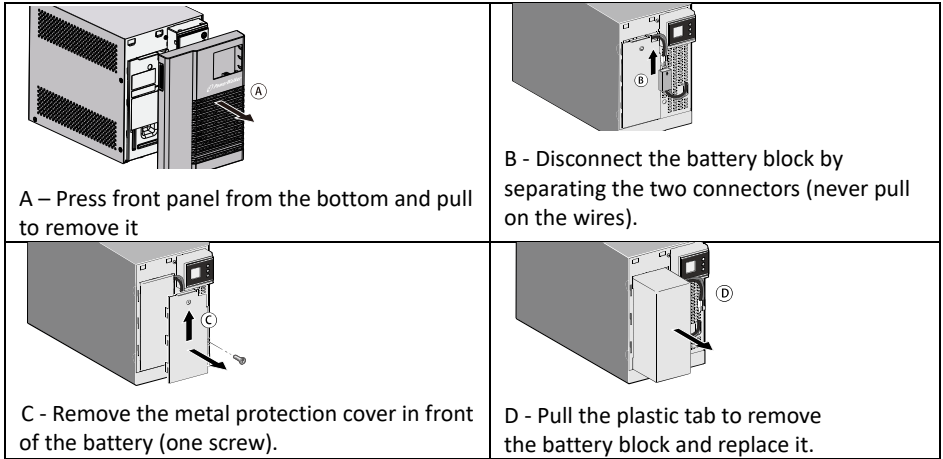

VI. Technical Specification

Model	VI THID Series
INPUT	
Voltage	220/230/240 VAC
Voltage Range	184~276 VAC
OUTPUT	
Voltage	220/230/240 VAC
Voltage Regulation	-10%/+6% of nominal voltage range(Line mode)
Frequency Range	50/60Hz
Frequency Regulation	±1Hz (Battery mode)
Transfer Time	Typical 3-7ms, 10ms max
Waveform	Pure Sine Wave
PROTECTION	
Full protection	Discharge, overcharge and overload protection
ENVIRONMENT	
Humidity	0-90 % RH @ 0° to 40° C (non-condensing)
Monitoring Software	WinPower

Model	VI 500 THID	VI 750 THID	VI 1000 THID	VI 1500 THID
POWER	500VA / 350W	750VA / 500W	1000VA / 700W	1500VA / 900W
Type & Number	12V/7Ah x1	12V/ 9Ah x1	12V/7Ah x2	12V/9Ah x2
Charging Time	3 hours recover to 90% Power			
Backup Time (Half SPS load)	10min	9min	11min	8min

Outlet and Connector	4 * IEC 320 C13 outlets, USB port, RJ11/RJ45 Surge Protection	8 * IEC 320 C13 outlets, USB port, RJ11/RJ45 Surge Protection		
Dimension (WxHxD)	150 mmx 209mm x 240mm	150mm x 209mm x 340mm		
Net weight	6.3kg	6.8kg	10.5kg	11.5kg